



36 Earn Crescent

, Wishaw, ML2 0PE

£800

NEW TO THE RENTAL MARKET!

Unfurnished and available now!

A stunning end terraced villa in Pather Wishaw, fully refurbished and renovated throughout, new carpets and freshly decorated.

Comprising entrance hall, large lounge, newly fitted kitchen, 2 double bedrooms and new bathroom suite.

Double Glazing. Gas Central Heating. Gardens to front and rear. Driveway to side

EPCC

LARN1812008

Viewing

Please contact our Pomphreys Properties Ltd Office on 01698373365 if you wish to arrange a viewing appointment for this property or require further information.

■ Stunning refurbished home!

■ New Kitchen

■ New Bathroom

■ Freshly decorated and carpeted throughout

■ New Central Heating System

■ Gardens to front and rear

■ Driveway to side



Floor Plan

36 Earn Crescent, Wishaw

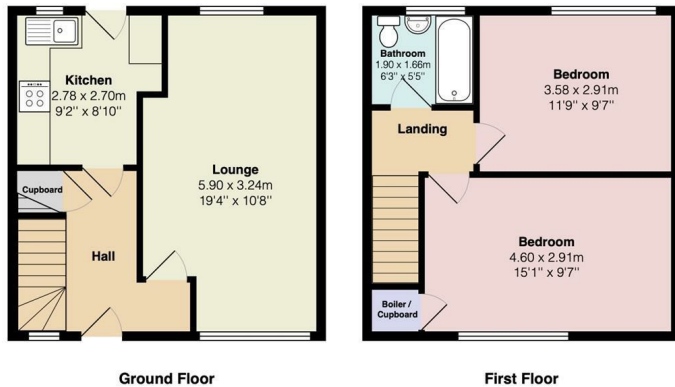

Total Area: 66.0 m² ... 710 ft²
All measurements are approximate and for display purposes only



Area Map



Energy Efficiency Graph



These particulars, whilst believed to be accurate are set out as a general outline only for guidance and do not constitute any part of an offer or contract. Intending purchasers should not rely on them as statements of representation of fact, but must satisfy themselves by inspection or otherwise as to their accuracy. No person in this firm's employment has the authority to make or give any representation or warranty in respect of the property.